



## 303 – 1621 Dufferin Crescent Nanaimo, BC

### Property Features

- A great opportunity to lease space in the Millstone Medical Building top floor unit.
- Located close to the Nanaimo Regional General Hospital this 1,137 Sq Ft executive medical office space opens to a spacious reception area, 2 offices, 2 exam rooms, kitchen area and a washroom with a shower.
- The Millstone Medical Building was completed in 2014 with ample parking for clients.
- The Lease includes two underground parking stalls.

### Lease Rate:

**\$30.00 per SF & OE&T of \$14.23 per SF**

CITY	Nanaimo
UNITS	1,137 SF
ZONING	CC-5
OCCUPANCY DATE	Immediately



For more information:

**John Hankins**  
250-713-9830  
• [jhankins@naicommercial.ca](mailto:jhankins@naicommercial.ca)

# FOR LEASE

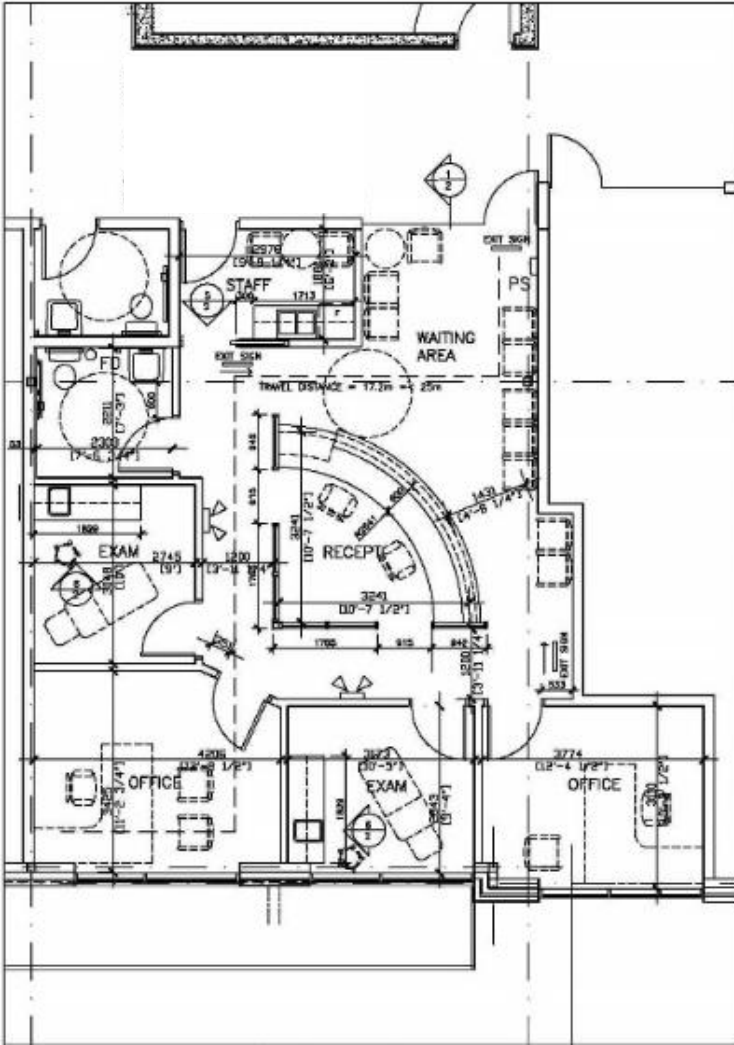

## Floor Plan



# FOR LEASE

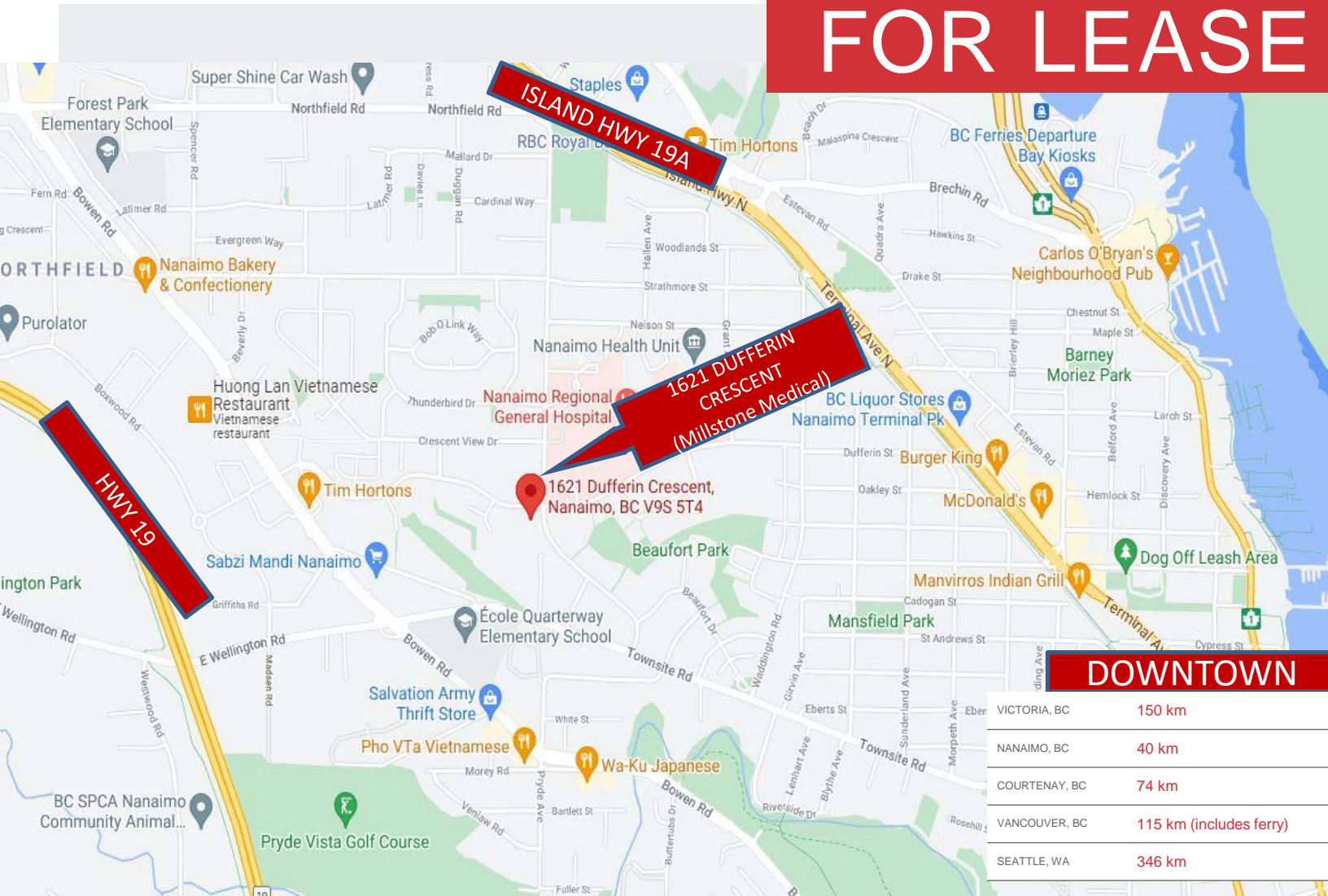

## Nanaimo and the Location Benefits

- Nanaimo is located on the east coast of Vancouver Island, 113 km north of Victoria, and 55 km across the Strait of Georgia from Vancouver. Nanaimo serves as the economic hub for the area north of Victoria. BC Ferry terminals in Departure Bay and Duke Point link Nanaimo directly to Metro Vancouver and the Nanaimo Airport is a 10 minute drive to the south.
- The City of Nanaimo is a classic West Coast community offering natural beauty at every turn and vast recreation potential, attracting a steady stream of new residents.

